

MIDIS

Faceplate connection instructions

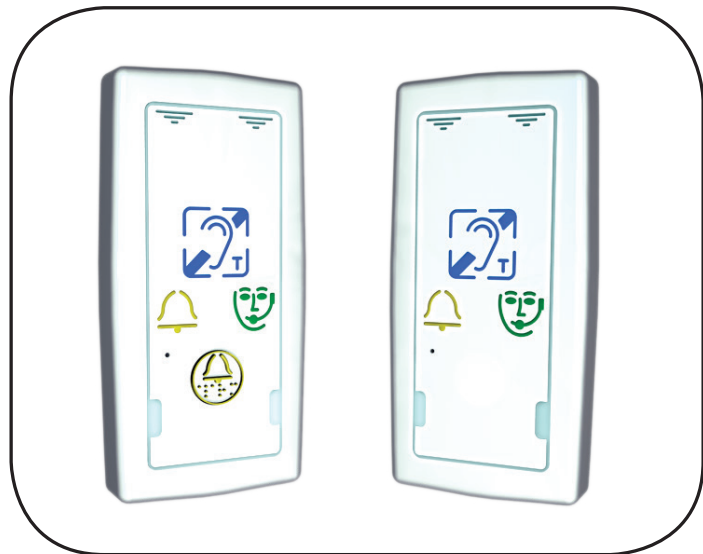

MIDIS Faceplate (with Alarm Button) NF car alarm button wiring

ANEP BOX TA / TX

Connect devices before ANEP BOX triggering.
Refer to instruction manual

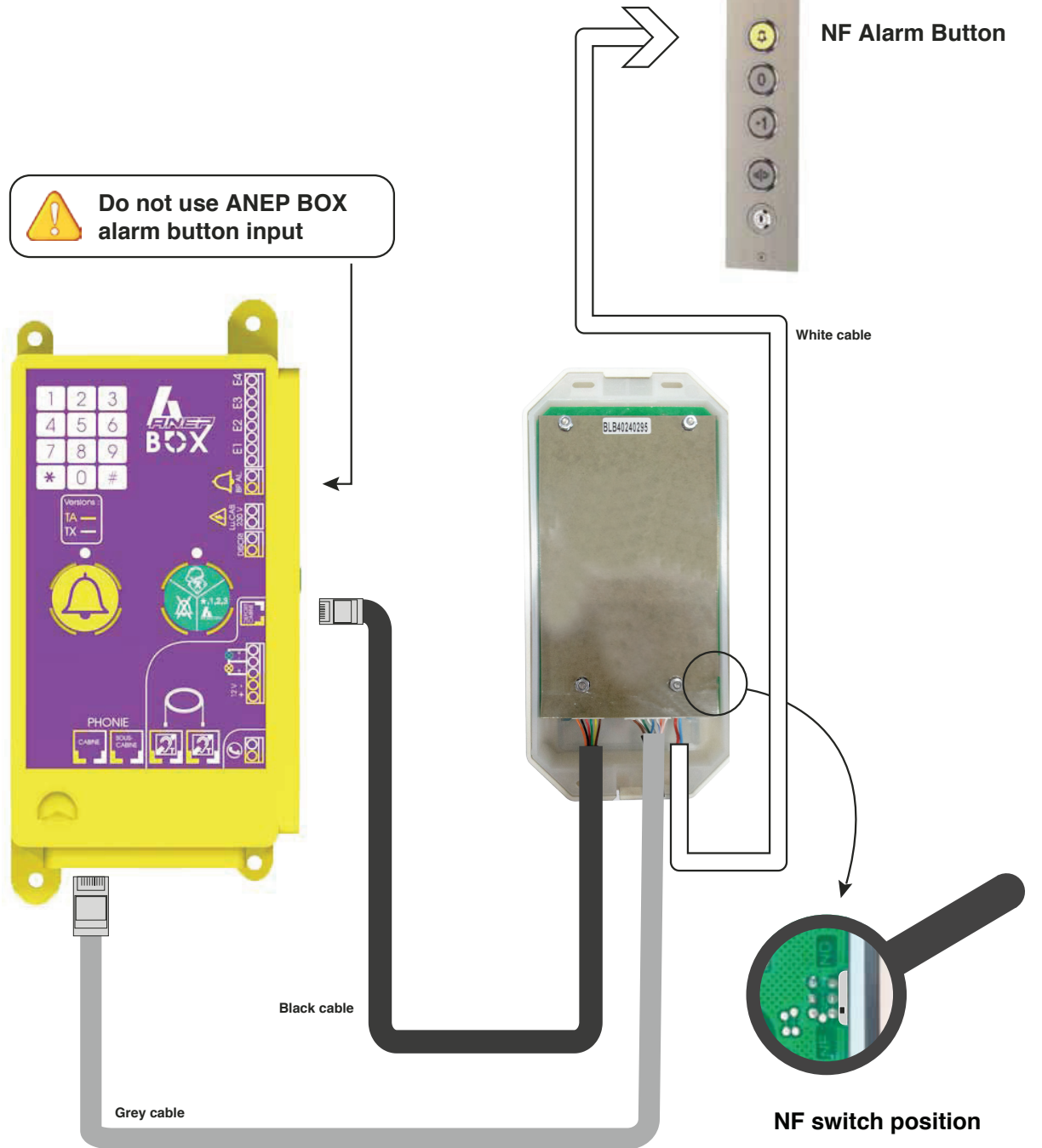

MIDIS Faceplate (with Alarm Button) NO Car alarm button wiring ANEP BOX TA / TX

Connect devices before ANEP BOX triggering.
Refer to instruction manual.



Possibility to connect an another NO alarm button

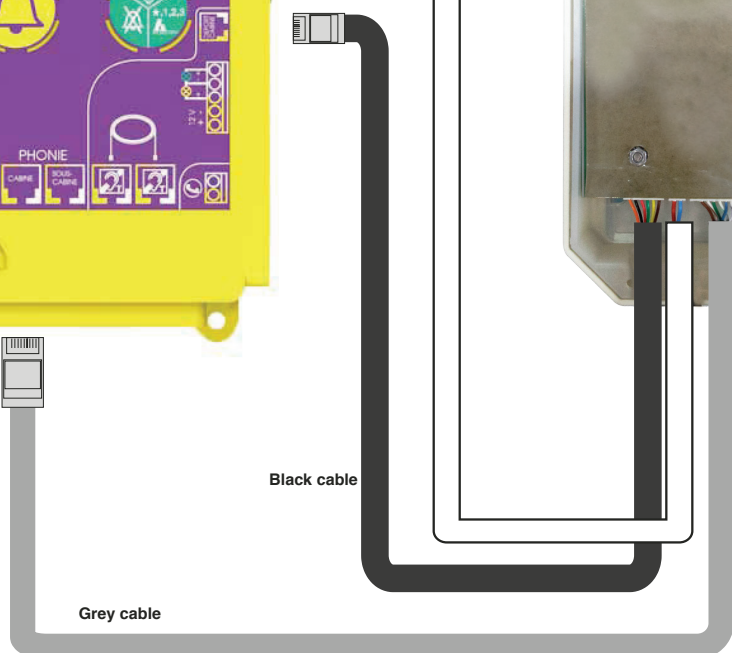
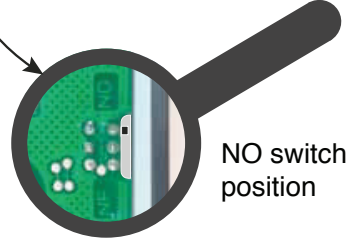
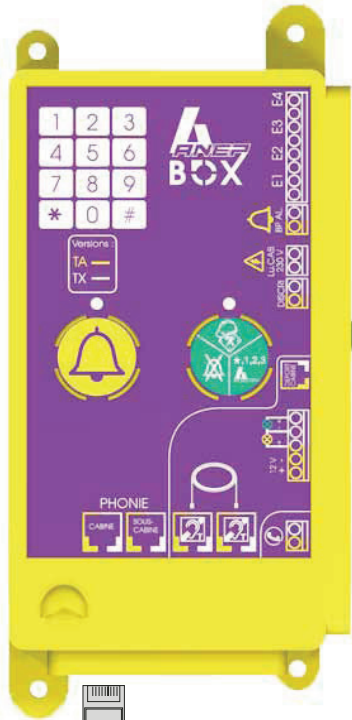

Dont remove the strap

MIDIS Faceplate (button less)

ANEP BOX TA / TX

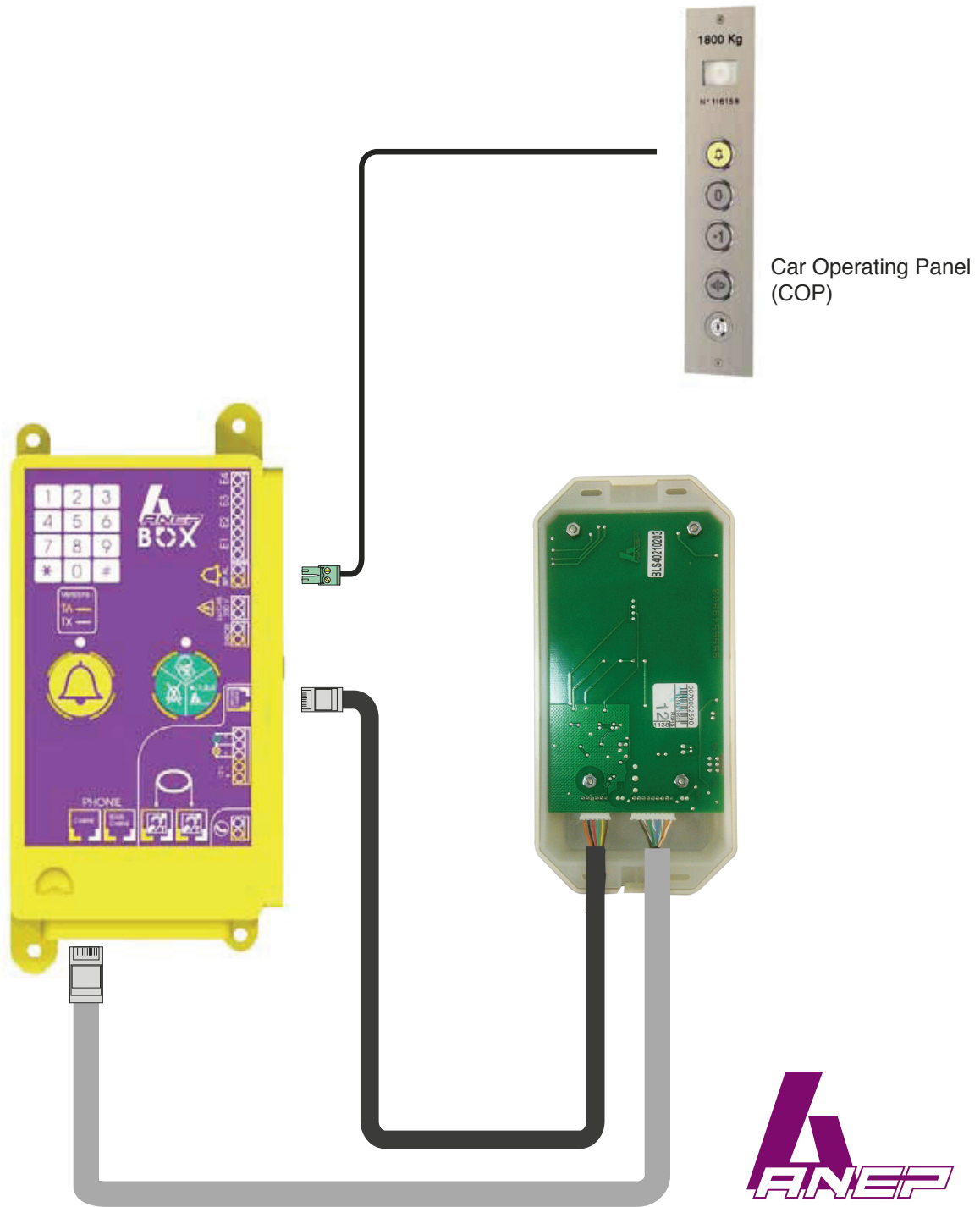



NOTES

ANEP applies a method of continuous development. ANEP reserves itself the right to make changes and improvements to any product described in this document, without previous information.

ANEP can in no way be held responsible for any loss of data, as well as any special damage or incident, consequential to poor implementation or improper use of the product.

The contents of this document are provided «as is». No warranties of any kind, either express or implied, is given as to the accuracy, reliability or contents of this document.

ANEP reserves itself the right to revise this document or withdraw it at any convenient time, without previous information.

WARRANTY

Regardless of the legal warranty that it benefits, this product is guaranteed for 1 year from the invoice date of the product, excluding batteries which are guaranteed for 6 months.

However, this warranty does not apply in the following cases :

- product not used in accordance with instructions contained in this manual.
- damages from an external cause to the product (vandalism, fire, flood, overvoltage).
- installation by an installer unqualified and uncertified by **ANEP**.
- modifications or repairs carried out by non approved entity by **ANEP**.

IMPORTANT

Particular care must be taken regarding the wiring and connections, to get the best sound results and optimum reliability of the product.

The equipment must be connected, installed and programmed in the rules of the art of the lift industry.

LE SERVICE APRÈS VENTE EST ASSURÉ PAR

SAVTEL

4 bis rue de Paris 94470 Boissy-Saint-Léger

Tel : 01 45 98 34 44

Fax : 01 45 69 75 45

Site internet : www.anepanywhere.com



www.anepanywhere.com