

Universal hoods for overspeed governors and shaft copying system pulleys

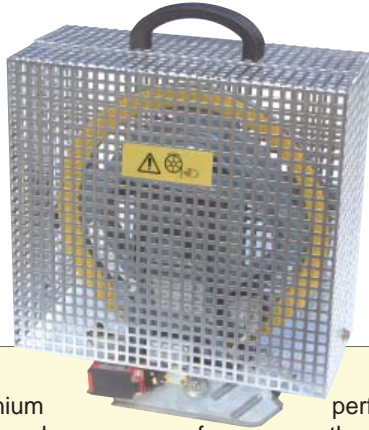

The cover consists of 8mm aluminium perforated sheet. Through this it is possible to make a sight check of the overspeed governor or of the shaft copying pulley at any time. With the provided butterfly nuts the hoods can quickly and easily be disassembled in case of inspections and maintenance.

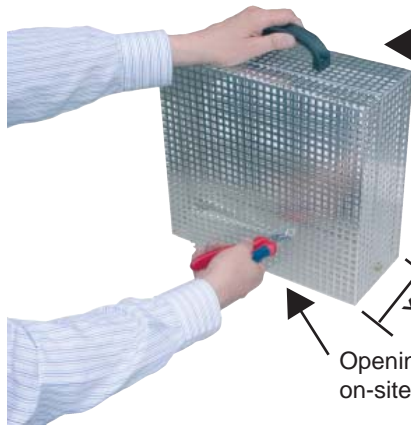

Handle for easy removal in case of maintenance and Technical Inspection Authority checks.

The cover depth is variably adjustable from 100mm to 175mm.

Openings for overlapping mounting parts can be cut out on-site with a side cutter.

Scope of delivery for type A, B, C, C1, C2



Scope of delivery for type D, E

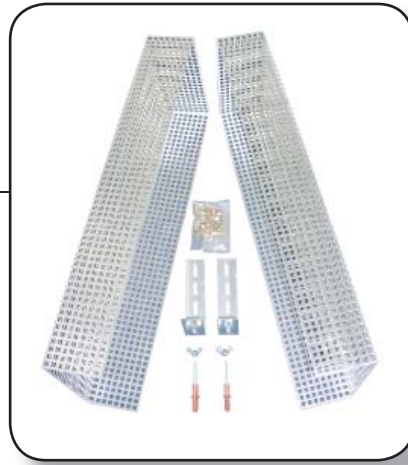

A mounting instruction is included in delivery.



Advice:

Please note the advice "Protective covers on rotating parts" on page 155.



© 10/2009

The internal dimensions of the hoods are indicated in mm.

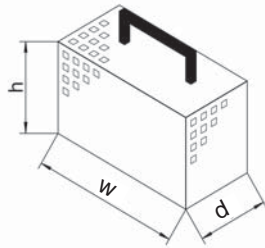

Type A Governor hood for Ø200 pulley, suitable for BODE governor
w=250, h=230, d=100-175

Art.no. 78627 Governor hood type A



Type C2 Governor hood for Ø300 and Ø400 pulleys, suitable for SCHINDLER type GBF

w=540, h=350, d=100-175

Art.no. 78294 Governor hood type C2



Standard 200

Type B Governor hood for Ø200 pulley, tall version; basically suitable for all standard governors, e.g. SCHINDLER GBP(D), JUNGBLUT, etc.

w=250, h=350, d=100-175

Art.no. 78210 Governor hood type B



Type D Hood for Ø200 governor or shaft copying pulley.

The hood can be fixed to the floor with dowels, angles and butterfly nuts (included in delivery).

w=250, h=680, d=100-175

Art.no. 78273 Cover hood type D



Standard 300

Type C Governor hood for Ø300 pulley, suitable for all standard governors

w=350, h=300, d=100-175

Art.no. 78628 Governor hood type C



Type C1 Governor hood for Ø200 and Ø300 pulley, suitable for Schindler type NR0, NR1 and others

w=350, h=430, d=100-175

Art.no. 78293 Governor hood type C1



Type E Hood for Ø300 governor or shaft copying pulley.

The hood can be fixed to the floor with dowels, angles and butterfly nuts (included in delivery).

w=350, h=800, d=100-175

Art.no. 78274 Cover hood type E

Contaminant deflector and cover for governor tensioning rope pulleys

Scope of delivery

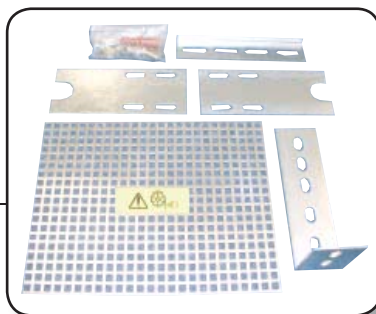

Art.no. 78270

Contaminant deflector 300 for Ø200 and Ø300 pulleys

78271

Contaminant deflector 400 for Ø200 and Ø400 pulleys



© 10/2009