

Mounting instruction

Guide rail lubricator

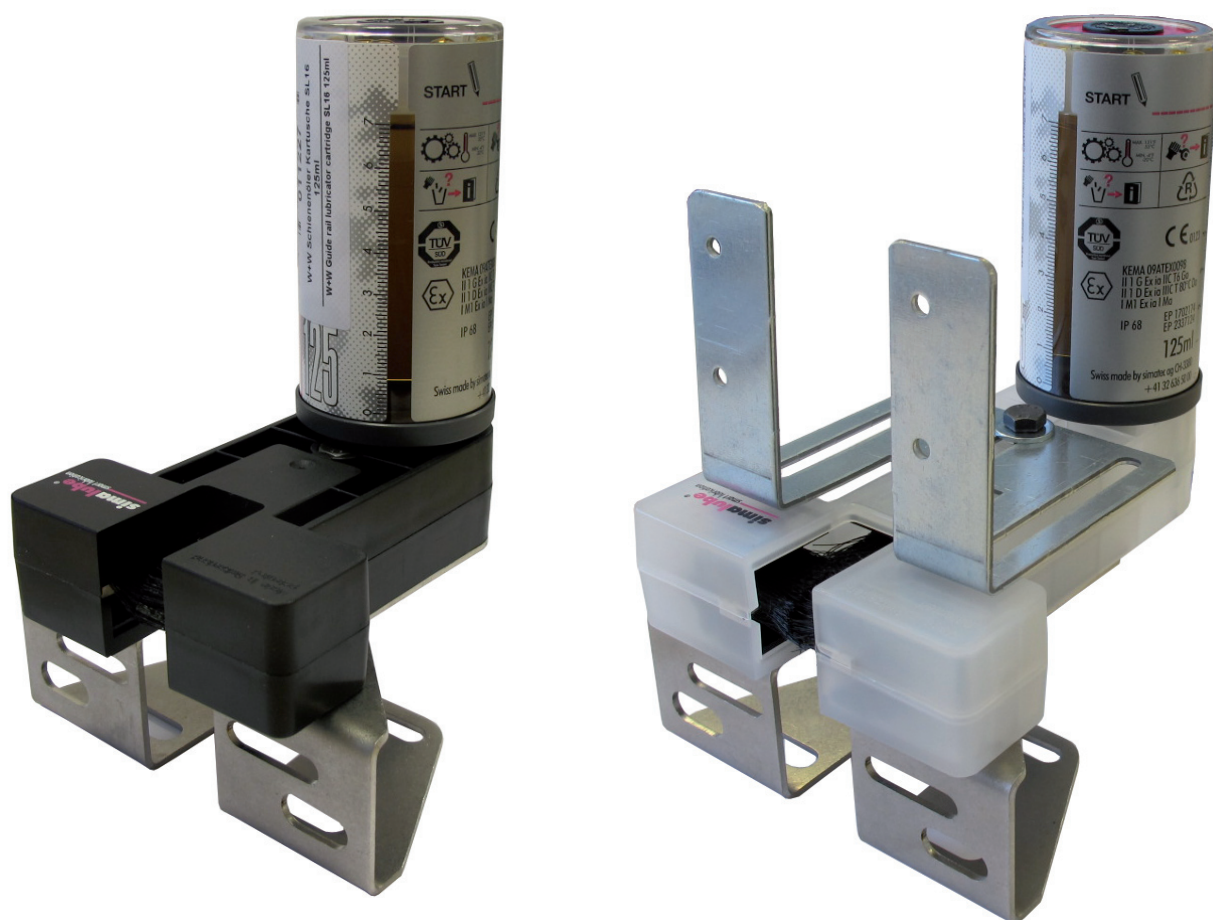

Warning notice:



The guide rail lubricator is only suitable for lubricating guide rails for lifts.



The mounting may only be carried out by specialised persons*.
All appropriate safety regulations and the necessary safety precautions for the elevator assembly are to be considered.

Keep the instructions on site for later use!

Technical data:

Operating temperature:	-20°...+55°C
Velocity:	≤ 2,5m/s
Connection cartridge:	1/4"
Lubricant SL16:	Water hazard class WGK 1
Classification acc. to EG 1272/2008:	This product is not classified according to the CLP regulation.

*specialised person (gem. EN81-20):

A person who has received training especially for lifts, who is qualified by knowledge and experience and who has received the instructions required for a safe execution of maintenance work, lift inspections or passenger releases.

601038



Fig. shows Art.no. 011220

Art.no.	Description
011220	W+W Guide rail lubricator set 5-16mm
011221	W+W Guide rail lubricator set 5-16mm with MSB*
011222	W+W Guide rail lubricator set 16-32mm with MSB*
011223	W+W Guide rail lubricator extension

MSB = sheet metal mounting plate for the magnetic switch

Scope of delivery :

- 2x Guide rail lubricators 5-16mm / 16-32
- 2x Mounting brackets for guide rail lubricators
- 2x Cartridges with lubricant SL16 125ml
- 2x Mounting plates for two magnetic switches (optional)
- 2x Small parts bag
- 1x Bottle of lubricant SL16 50ml
- 1x Mounting instructions

1.
At first fix the mounting brackets on the cabin or at the counterweight. Use the screws corresponding to the holes. Often there are already holes prepared in the guide shoes.

2.
Fasten the guide rail lubricator at the mounting bracket by means of the screw M6x45, the washer and the self-locking nut M6.
If need be, mount the sheet metal plate for the magnetic switch as well.

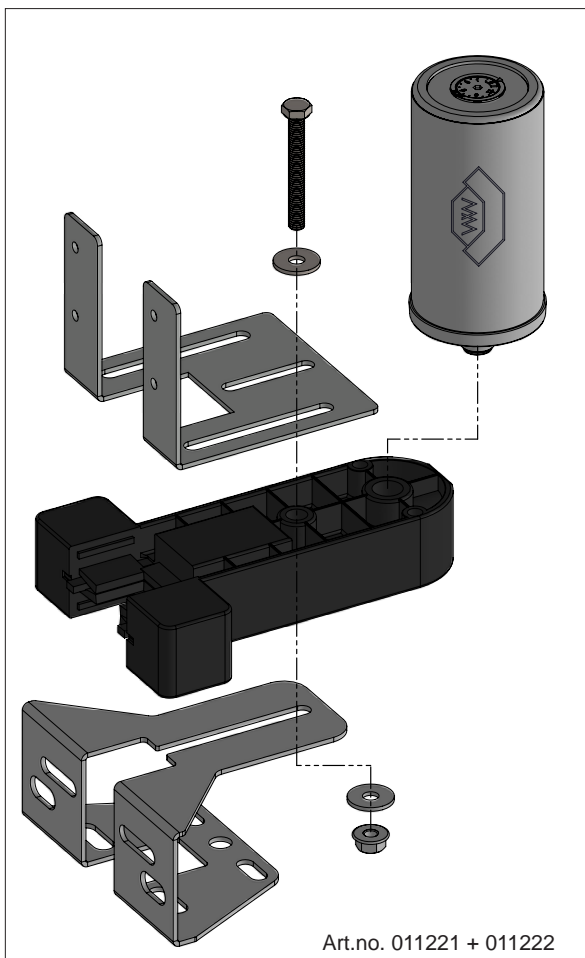

Art.no. 011221 + 011222

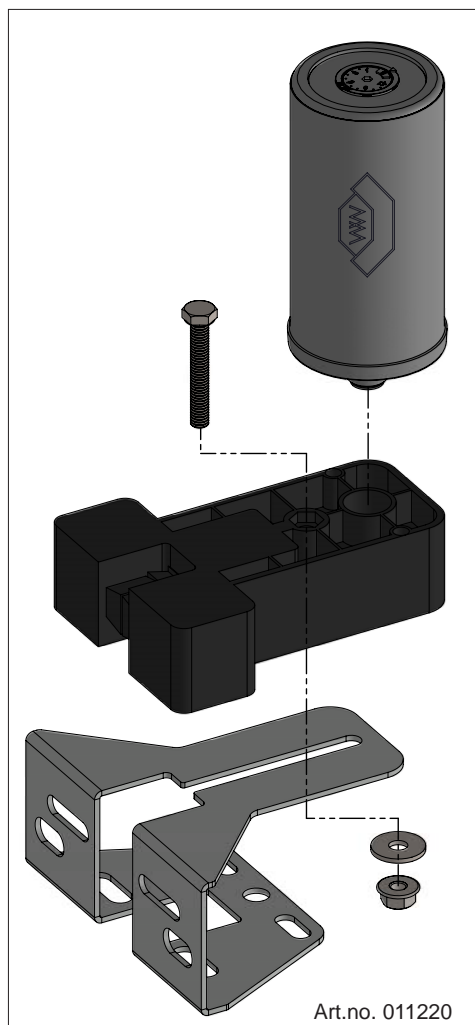

Art.no. 011220

The brushes have to be adjusted centrally to the rail. The bristle on the front side shall be pushed in for about 3mm.

If magnetic switches are used, the magnets have to be relocated afterwards.

3. Fill the guide rail lubricator with approximately 5ml of oil. Thus the internal oil distribution is prefilled. Additionally, wet the bristles with oil.



4. Cut off the yellow top of the fitting.
Attention: Do not remove the entire yellow plug!



5. Screw the cartridges into the corresponding connections and tighten them by hand.



6. Adjustment of the dispensed quantity:
The numbers indicate the duration in months until the 125ml cartridge will be empty. The adjustment depends on the ambient conditions and the number of rides:

- Clean and dry surroundings: 6 - 12 months
- Dirty and humid surroundings: 3 - 6 months



Art.-no. 011223 W+W guide rail lubricator extension

Scope of delivery :

- 1x Retaining clamp for the cartridge 50mm
- 1x Push-in fitting G1/4" internal screw thread
- 1x Angled screw coupling G1/4" external screw thread
- 1x Flexible tube for rail lubricator, length 1m
- 1x Magnetic base for the retaining clamp



Screw the angled screw coupling in the lubricator and tighten it. Screw the push-in fitting on the (open) cartridge. Screw the magnetic base with the M6 threaded plate to the retaining clamp.

Keep the flexible tube as short as possible. Place the cartridge near the guide rail lubricator. There is no designated place for the cartridge.

In advance prefill the flexible tube with oil.

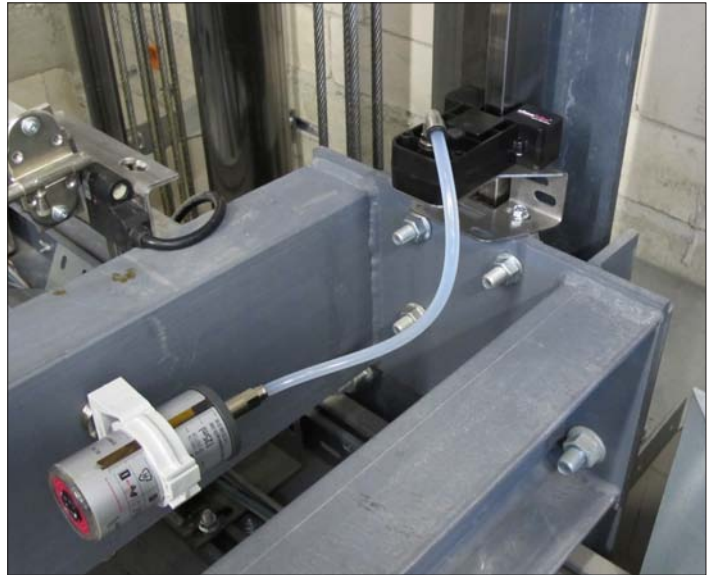
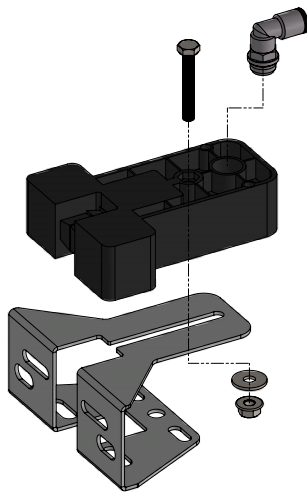

Spare and wear parts



Art.no.	Description
011227	W+W Guide rail lubricator cartridge SL16 125ml
011224	W+W Guide rail lubricator 5-16mm (without MSB)
011225	W+W Guide rail lubricator 5-16mm (with MSB)
011226	W+W Guide rail lubricator 16-32mm
011228	W+W Guide rail lubricator mounting bracket

MSB = sheet metal mounting plate for the magnetic switch

Distributor:

W+W Aufzugkomponenten GmbH u. Co.KG
Erkrather Straße 264-266
40233 Düsseldorf
Germany

The safety data sheet for the lubricant can be downloaded from www.wwlift.de.

Disposal



- a) Remove the round seal.
- b) Unscrew the power head with the socket wrench SW21.

Dispose the undissected power head in the battery recycling bin and the empty housing in the plastics recycling bin.